



MANUAL DE INSTRUCCIONES  
 OPERATING INSTRUCTIONS  
 MODE D'EMPLOI  
 GEBRAUCHSANWEISUNG  
 MANUALE D'ISTRUZIONI  
 MANUAL DE INSTRUÇÕES  
 ИНСТРУКЦИЯ ПО ЭКСПЛУАТАЦИИ



página/page  
 seite/pagina  
 страница

<b>ESPAÑOL</b>	Cepillo lijador de curvas CE123N	2
<b>ENGLISH</b>	CE123N Abrasive curved planer	5
<b>FRANÇAIS</b>	Rabot ponceur cintrable CE123N	7
<b>DEUTSCH</b>	Kurvenschleifhobel CE123N	10
<b>ITALIANO</b>	Pialletto abrasivo per curve CE123N	13
<b>PORTUGUÊS</b>	Plaina lixadora de curvas CE123N	16
<b>РУССКИЙ</b>	CE123N Шлифовальный Рубанок Криволинейный	19

## Español

### CEPILLO LIJADOR DE CURVAS CE123N

(Ver imagenes pag. 22, 23)

#### 1. INSTRUCCIONES DE SEGURIDAD PARA EL MANEJO DEL CEPILLO

¡ATENCIÓN! Antes de utilizar la máquina, lea atentamente el FOLLETO DE INSTRUCCIONES GENERALES DE SEGURIDAD que se adjunta con la documentación de la misma.

1. Asegúrese antes de conectar la máquina, que la tensión de alimentación, corresponda con la indicada en la chapa de características.

2. Antes de poner en marcha la máquina, asegúrese que el rodillo abrasivo esta bien sujeto y no roza con ninguna otra parte de la máquina.

3. Antes de empezar el trabajo, asegúrese que la superficie a lijar no tiene clavos o ángulos afilados que puedan dañar el rodillo abrasivo.

4. Mantenga siempre las manos alejadas del área de lijado, y sujete siempre la máquina por la empuñadura.

5. El polvo producido durante el lijado puede resultar tóxico o nocivo para la salud. Es necesario utilizar siempre la conexión para la aspiración de polvo.

6. También es recomendable trabajar con aspiración, para prolongar la vida del rodillo abrasivo.

7. Esperar a que la máquina este completamente parada antes de soltarla o apartarla.

8. Desconecte la máquina de la red eléctrica antes de realizar cualquier operación de mantenimiento.

9. Deberían utilizarse protectores auditivos durante el uso de la máquina (Ver capítulo13)

10. Use siempre recambios originales VIRUTEX.

#### 2. CARACTERÍSTICAS TÉCNICAS

Potencia absorbida.....	700 W
Motor universal.....	50/60 Hz
R. p.m en vacío.....	16.500
Ancho de lijado.....	81 mm
Profundidad de lijado máx.....	1 mm
Nivel de presión acústica continuo equivalente ponderado A.....	86 dB(A)
Nivel de potencia acústica.....	99 dB(A)
Nivel vibraciones habitual (mano/brazo).....	<2,5 m/s <sup>2</sup>
Peso.....	3,2 Kg

#### 3. EQUIPO ESTÁNDAR

En el interior de la caja Ud. encontrará los elementos siguientes:

1. Cepillo lijador CE123N equipado con rodillo abrasivo de Grano 50
2. Toma aspiración
3. Manual de instrucciones

condiciones de uso.

Mantener libres y limpias, las aberturas de ventilación y refrigeración de la máquina.

### 13. NIVEL DE RUIDO Y VIBRACIONES

El nivel de ruido y vibraciones de esta herramienta eléctrica ha sido medido de acuerdo con la Norma Europea EN50144.

El nivel de ruidos en el puesto de trabajo, puede sobrepasar los 85dB(A). En este caso es necesario que el usuario tome medidas de protección contra el ruido.

### 14. GARANTÍA

Todas las máquinas electroportátiles VIRUTEX tienen una garantía válida de 12 meses, a partir del día de su suministro, quedando excluidas todas las manipulaciones o daños ocasionados por manejo inadecuado o por desgaste natural de la máquina.

Para cualquier reparación, dirigirse al Servicio Oficial de Asistencia Técnica VIRUTEX.

VIRUTEX, se reserva el derecho de modificar sus productos sin previo aviso.

## English

### CE123N ABRASIVE CURVED PLANER

(See figures in pages 22, 23)

#### 1. SAFETY INSTRUCTIONS FOR HANDLING THE PLANER

**WARNING!** Before using the machine, carefully read the GENERAL SAFETY INSTRUCTIONS LEAFLET enclosed with the machine documentation.

1. Before plugging in the machine, ensure that the power supply voltage corresponds to what is stated on the machine's characteristics plate.
2. Before starting up the machine, ensure that the abrasive roller is properly fastened in place and does not rub against any other part of the machine.
3. Before starting to work, make sure that there are no nails or sharp angles on the surface to be sanded that could damage the abrasive roller.
4. Always keep hands clear of the sanding area and grasp the machine by the handgrip.
5. The dust produced during sanding may prove to be toxic or harmful to your health, and therefore it is necessary that the machine always be

connected to a dust collector.

6. It is also recommended that dust collection be used in order to prolong the life of the abrasive roller.
7. Wait until the machine has come to a complete stop before putting it down or storing it.
8. Unplug the machine from the electrical outlet before performing any maintenance operations.
9. Wear earplugs when using the machine (see chapter 13)
10. Always use original VIRUTEX spare parts.

### 2. SPECIFICATIONS

Input power.....	700 W
Motor.....	50/60Hz
No-load speed (rpm).....	16,500
Sanding width.....	81 mm
Max. sanding depth.....	1 mm
Equivalent measured continuous acoustic pressure level A.....	86 dB(A)
Level of acoustic power.....	99 dB(A)
Normal level of vibrations (hand-arm).....	<2,5 m/s <sup>2</sup>
Weight.....	3.2 Kg

### 3. STANDARD EQUIPMENT

Inside the box you will find the following components:

1. CE123N abrasive planer fitted with 50-grain abrasive roller.
2. Dust collector nozzle
3. Instructions manual

### 4. TOOLS

#### CODE DESCRIPTION

2345510	40-grain Carborundum abrasive roller
2345511	50-grain Carborundum abrasive roller
2345512	60-grain Carborundum abrasive roller
2345513	80-grain Carborundum abrasive roller
2345514	60-grain zirconium oxide abrasive roller

### 5. GENERAL DESCRIPTION AND APPLICATIONS

The CE123N abrasive planer is a tool that will prove useful to carpenters, fitters, restorers and shipwrights. The planer is equipped with a front skid and a rear base, whose adjustable radiuses enable the machine to adapt for the planing of concave and convex surfaces. It is especially designed for the shaving and/or sanding of: wood, varnished wood, stratified wood, softwood and such materials as fibreglass and

carbon fibre reinforced with epoxy, vinyl and polyester resins.

For maximum performance, work with the machine without forcing it, which reduces its speed and output.

The machine is equipped with a dust collector connection which can be used for connection to our AS182K, AS282K dust collector or any industrial equivalent via the STANDARD DUST COLLECTOR ATTACHMENT (ref. 6446073). For assembling the dust collector connection, remove the chips outlet guide A (Fig. 1) using screws B and fit the dust collector connection in its place.

---

## 6. STARTING AND STOPPING THE MACHINE

The planer is equipped with an upwardly-engaging safety button, which avoids the machine from being started up accidentally.

To start up the machine, press down on the safety button D while depressing the power button E (Fig. 2).

---

## 7. ADJUSTMENTS

### 7.1 SANDING OF CONCAVE SURFACES

#### Approximation sanding

Trace the reference line R for approximation sanding (Fig. 3).

Set the cutting depth to "0" using knob G (Fig. 3). Adjust the skid H and the base I (Fig. 3) to a radius somewhat less than that which is going to be worked on, using knobs J and K (Fig. 3). Set the skid to the desired cutting depth using knob G (Fig. 3). Proceed to sand down irregularities, using the skid as the supporting surface to begin the cut, working successively on rough areas in order to approach the reference line.

#### Finish sanding

In order to sand a constant thickness along the length of a concave surface, or to give a continuous finishing pass, proceed as follows:

Set the pass depth to "0" using knob G (Fig. 4). Loosen knobs J and K that fasten the skid H and the base I (Fig. 4). Place the planer on the surface to be sanded, pressing down on it so that the skid H and the base I adapt to it, fixing them in place using knobs J and K (Fig. 4). Ensure the parallelism of the skid and the base by checking that the same level is indicated on the guide marker L on the struts M (Fig. 4) on

both sides of the planer. Lastly, set the desired cutting depth using knob G (Fig. 4).

To sand the piece, use the skid as the supporting surface to begin the cut, gradually shifting the support to the entire base as you progress.

### 7.2 SANDING OF CONVEX SURFACES

#### Approximation sanding

Trace the reference line R for approximation sanding (Fig. 5).

Loosen knob J, set the cutting depth to "0" using the knob G and fix the skid in place with knob J in the horizontal position (Fig. 5).

Place the planer on the piece to be sanded. Give the base I (Fig. 5) a slightly greater radius than that of the piece and fix it in place using knob K (Fig. 5). Adjust the desired cutting depth using the knob G (Fig. 5).

To sand irregularities by areas, use either the skid or the base as the support surface to begin sanding, depending on which is more convenient, and once on the piece the position of the planer should be shifted slightly so that the support is on the ends nearest the sanding roller as depicted in (Fig. 5).

#### Finish sanding

In order to sand a constant thickness along the length of a convex surface, or to give a continuous finishing pass, proceed as follows:

Set the pass depth to "0" using knob G (Fig. 6). Loosen knobs J and K that fasten the skid H and the base I (Fig. 6). Place the planer on the surface to be sanded, adapting the skid H and the base I to it and fixing them in place using knobs J and K, respectively (Fig. 6). Ensure the parallelism of the skid and the base by checking that the same level is indicated on the guide marker L on the struts M (Fig. 6) on both sides of the planer. Adjust the desired cutting depth using the knob G (Fig. 6).

To sand the piece, use the skid as the supporting surface to begin the cut, gradually shifting the support to the entire base as you progress.

### 7.3 SANDING OF FLAT SURFACES

Loosen knobs J and K (Fig. 7) in order to release the front skid and the base from the curvature struts.

Set the skid H to "0" using knob G (Fig. 7). Place the planer on a flat surface and press down on the rear part of the base I, so that it

adapts to the horizontal plane; then tighten knob K (Fig. 7). Set the skid H to the desired cutting depth using the knob G and tighten knob J in this position (Fig. 7).

---

## 8. CHANGING THE ABRASIVE ROLLER

**WARNING!** Unplug the machine from the electrical outlet before performing any maintenance operation.

In order to change the abrasive roller, proceed as follows:

- Loosen knob N (Fig. 8)
- Remove the protective cover O (Fig. 8), first lifting it by the tab and swivelling it until the abrasive roller P can be accessed freely (Fig. 8)
- Loosen the lock nut Q (Fig. 8)
- Remove the abrasive roller P (Fig. 8), sliding it off laterally.

**WARNING!** Ensure that the roller head S (Fig. 9) is totally free of chips, dust, etc, before installing the new abrasive roller.

Before inserting the new roller, also check that the O-ring seals T-U (Fig. 9) are in good condition and show no signs of cracking or pitting, and are correctly fitted in place.

Insert the new roller, following the steps provided for disassembly in inverse order.

---

## 9. CHANGING O-RING SEALS

If it is observed that O-ring seals are worn out, proceed as follows to replace them:

- Remove the nut Q, the press cap V and the O-ring seals T (Fig. 9), replacing them with new original VIRUTEX seals.
- Remove the O-ring seals U from their grooves in the roller head S and press cap V, replacing them with new original VIRUTEX seals (Fig. 9)

---

## 10. CHANGING THE TRANSMISSION BELT

Unscrew screws W (Fig. 10) and remove protection X. Replace the worn belt Y with a VIRUTEX original spare, taking care to fit it correctly into the pulley cogs, never forcing it.

---

## 11. MAINTENANCE OF THE BRUSHES AND COLLECTOR

**WARNING!** Disconnect from the mains before carrying out any maintenance operations.

The brushes must be replaced when they reach a minimum length of 5 mm (Fig. 9)

Unscrew the black caps Z (Fig. 9) on the housing and remove the brushes from the guide. Replace them with new Virutex original spares, ensuring

that they move smoothly inside the guides. Screw on the cap which covers them and leave the machine running for 15 minutes.

**WARNING!** If the collector is burned or uneven it should be repaired by a Virutex service agent.

---

## 12. CLEANING THE MACHINE

It is important to always clean the machine carefully after use with a dry air blower.

Keep the power cable in perfect condition.

Keep the machine's vent and cooling openings clean and unobstructed.

---

## 13. NOISE AND VIBRATION LEVEL

The noise and vibration levels of this electrical device have been measured according to the European standard EN50144.

The noise level in the workplace can exceed 85 dB(A), in which case it is necessary for the user to take noise protection measures.

---

## 14. WARRANTY

All VIRUTEX power tools are guaranteed for 12 months from the date of purchase, excluding any damage which is a result of incorrect use or of natural wear and tear on the machine. All repairs should be carried out by the official VIRUTEX technical assistance service.

VIRUTEX reserves the right to modify its products without prior notice.

## *Français*

### RABOT PONCEUR CINTRABLE CE123N

(Voir images p. 22, 23)

#### 1. INSTRUCTIONS DE SÉCURITÉ POUR LE MANIEMENT DU RABOT

**ATTENTION!** Avant d'utiliser la machine, veuillez lire attentivement la BROCHURE D'INSTRUCTIONS GÉNÉRALES DE SÉCURITÉ qui est jointe à la documentation de la machine.

1. Vérifier avant de brancher la machine si la tension d'alimentation correspond à celle indiquée sur la plaque des caractéristiques.

2. Avant de mettre en marche la machine, s'assurer que le rouleau abrasif est bien fixé et ne frotte pas sur une partie quelconque de la machine.

3. Avant de commencer à travailler, s'assurer que la surface à poncer n'a pas de clous ou

## 11. УСТАНОВКА ЩЕТОК И КОЛЛЕКТОРА

ВНИМАНИЕ! Всегда отключайте рубанок от сети перед выполнением каких-либо ремонтных операций.

Щетка должна быть заменена, если ее длина достигла 5 мм. (рис. 9)

Вышедшая из строя щетка должна быть заменена следующим образом:

Отвинтите черные фиксаторы Z (рис. 9) и удалите изношенные щетки из направляющей. Замените ее новой оригинальной фирмы VIRUTEX, убедившись в том, что щетка скользит свободно в направляющей.

Установите фиксаторы на прежнее место, оставьте машину на холостом ходу на 15 минут, чтобы убедиться в том, что щетки правильно «сели».

ВНИМАНИЕ! Необходимо проверять состояние выходного отверстия коллектора, и при необходимости осуществлять его ремонт в фирменных сервисных центрах VIRUTEX.

## 12. ЧИСТКА МАШИНЫ

Очень важно чистить машину каждый день после работы, продувая сухим воздухом. Содержите кабель в хороших условиях.

Не закрывать вентиляционные отверстия машины.

## 13. УРОВЕНЬ ВИБРАЦИИ И ШУМА

Уровень шума и вибрации указанного электрического инструмента был замерен в соответствии с Европейским Стандартом EN50144.

Уровень шума на рабочем месте может превышать 85 дБ (А), поэтому пользователь должен использовать шумопонижающие средства.

## 14. ГАРАНТИЯ

Все изделия фирмы VIRUTEX имеют гарантию 12 месяцев с момента поставки.

Гарантия не распространяется на ущерб или повреждения, возникшие в результате некорректного использования или естественного износа изделия.

Любой ремонт должен выполняться на уполномоченных станциях техобслуживания VIRUTEX.

Фирма VIRUTEX оставляет за собой право на внесение изменений в свои изделия без предварительного уведомления.

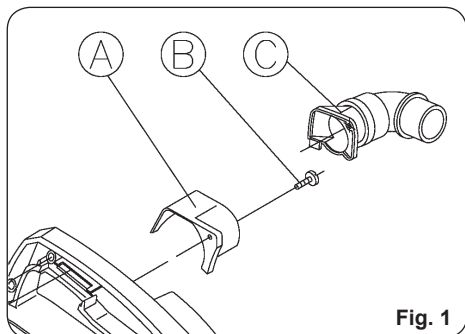

Fig. 1

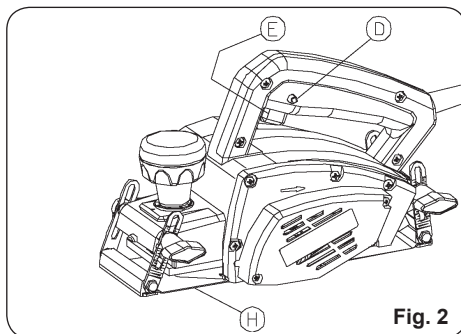

Fig. 2

